

Model: CAM122

1080P Full HD Vandal proof Mini Dome Network Camera

Features

- 1/2.8" 2.1 Megapixel Progressive Scan Sony CMOS
- H.264 & MJPEG dual-stream encoding
- Max 30fps@1080P (1920x1080)
- WDR, Day/Night, AWB, AGC, BLC
- Multiple network monitoring: Web viewer, CMS, Smart phone
- Fixed lens 2.6mm
- POE or 12VDC
- Micro SD Card Slot



Specification

Model	IP66	POE	LENS
CAM122	Yes	Yes	2.6mm Fixed Lens
Camera			
Image Sensor	1/2.8" 2.1 Megapixel Progressive Scan Sony CMOS		
CPU	HI3516C with 500MHZ		
Effective Pixels	1920x1080		
Scanning System	Progressive		
Electronics Shutter Speed	Auto (1/25,1/30 ~ 1/10000s)		
Min. Illumination	0.05Lux/F1.2 (Color), 0.005Lux/F1.2(B/W); 0Lux/F1.2 (IR on)		
S/N Ratio	>50dB		
Camera Features			
Day/Night	Color / B/W		
Backlight Compensation	BLC / HLC / WDR (digital)		
White Balance	Auto		
Gain Control	Auto		
Noise Reduction	3D		
Privacy Masking	Up to 4 Areas		
Lens			
Focal Length	2.6mm		
Max Aperture	F1.4		
Focus Control	Manual		
Angle of View	97°~ 67°		
Lens Type	Fixed Iris		
Mount Type	Board-in Type		
Video			
Compression	H.264 Main Profile, Baseline / MJPEG		
Resolution	1920x1080, 1280x720 ; 640x320, 320x160, 160x112		
Frame Rate	Preferred Stream	1920x1080(1~25/30fps), 1280x720 (1~25/30fps)	
	Alternate Stream	640x320, 320x160, 160x112 (1~25/30fps)	
Bit Rate	32KB ~16Mbps, support VBR, CBR		
Network			
Ethernet	RJ-45 (10/100Base-T)		
Protocol	IPv4/IPv6, HTTP, TCP/IP, UDP, RTP, RTCP, UPNP, RTSP, SMTP, NTP, DHCP, DNS, PPPOE, DDNS, FTP,		
ONVIF	ONVIF Ver. 2.0		
Max. User Access	5 users		
Smart Phone	iPhone, iPad, Android, Symbian		
Auxiliary Interface			
Memory Slot	Micro SD, Max 32GB		
General			

Model: CAM122

Power Supply	DC12V, POE (802.3af)
Power Consumption	≤2W
Working Environment	-20 °C ~ 60°C
Dimensions	Φ107mm ×53.4mm
Weight	0.5KG
Warranty	1 Year Advanced Replacement

Dimensions (mm)

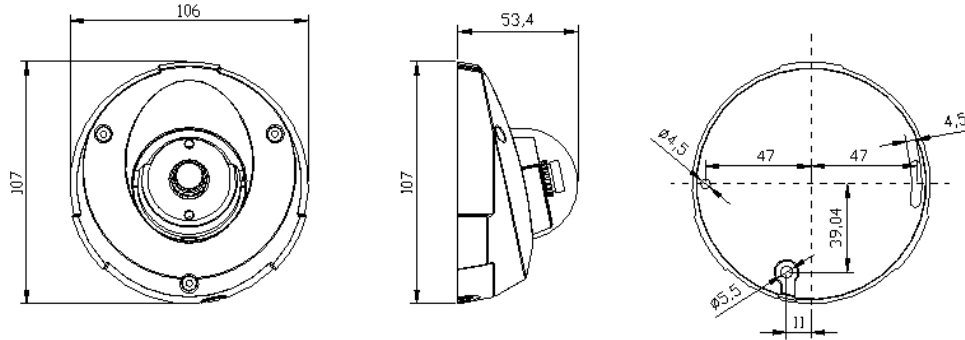

Interfaces:

